

SOLUTION

BENDING



EG 4010



ULTRA-HIGH PRODUCTIVITY AND PRECISION, BY ERGONOMIC SERVO PRESS BRAKE

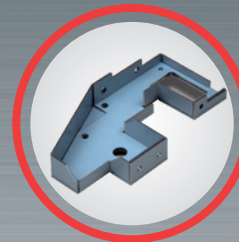
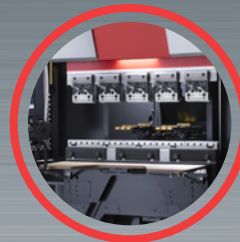

AMADA

EG 4010

ULTRA-HIGH PRODUCTIVITY AND PRECISION, BY ERGONOMIC SERVO PRESS BRAKE

THE BEST PRODUCTIVITY FOR SMALL PARTS

The exclusive AMADA Dual Servo Power (DSP) Drive - Extremely fast, reactive and dynamic – provides faster cycle times and more parts per hour.

Key features of the EG-4010 – ergonomic design and features for comfortable working, high productivity and accuracy, user friendly and connected NC, compact body and foot print and Delta-X back gauge for small complex workpiece processing.



Photograph may include optional equipment

MAIN FUNCTIONS

1 HIGH PRODUCTIVITY

HIGH PERFORMANCE UPPER BEAM & BACK GAUGE

The EG-4010 is equipped with a unique DSP system based on servo technology, which is able to guarantee the best performance in terms of speed, dynamics and positioning accuracy.

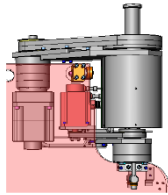

Handling of small part is often very quick; The EG-4010 5 axis back gauge system, offers an extremely fast and accurate positioning, avoiding wasting time during processing.

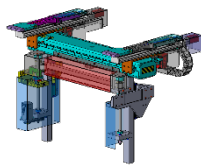

2 FULLY ERGONOMIC

COMFORT & PRODUCTIVITY

Several ergonomic features have been designed for operator comfort and to improve overall productivity, whilst reducing defects caused by operator fatigue.

- Adjustable chair
- Adjustable CNC position with flexible pendant arm
- Adjustable front table
- Adjustable foot rest
- Comfortable environment work lighting & low noise



3 HIGH ACCURACY

ADVANCED ANGLE AND GAUGING SOLUTION

The EG-4010 offers an advanced solution for accurate and reliable production.

ANGLE SOLUTION:

- TDS
- Force control
- Bi-J (option)



GAUGING SOLUTION:

- Delta X back gauge
- U-Shape finger

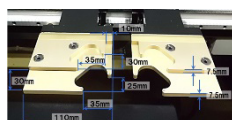

4 COMPACT AND GREEN

FLEXIBLE POSITIONNING

Thanks to its small foot print EG-4010 allow factories to save space, whilst providing a capable 40 ton press capacity.

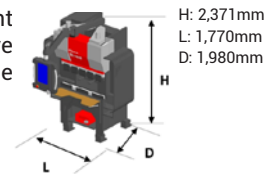

Power consumption is reduced by around 50% compared with conventional press brake.

Drastic reduction of maintenance cost thanks to «oil free» solution.

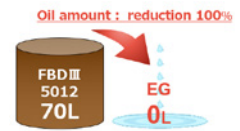

5 SMART PROGRAMMING

INTELLIGENT, INTERACTIVE, INTEGRATED

The AMNC 3i control is equipped with a large touchscreen and graphical interface to simplify operation.



VPSS 3i suite allows easy and automatic off-line programming by auto batch mode and common tool layout. (Option)



6 FLEXIBLE TOOLING SOLUTIONS

FAST SETUP

SGRIP (standard)



AGRIP-M (option)



AFH Tools

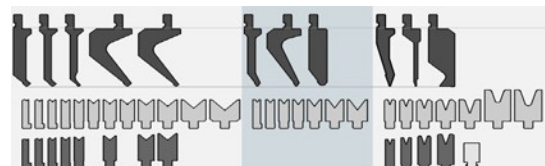

MACHINE DIMENSIONS

Units: mm

EG-4010

(L) 1770 x (W) 1980 x (H) 2371*

Dimension includes NC with pendant arm at maximum extension

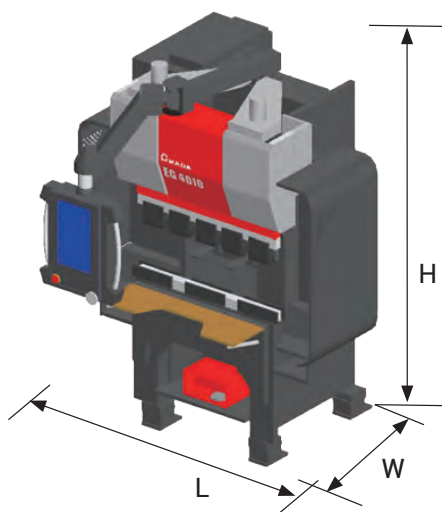

*with 50 mm high block

MACHINE SPECIFICATIONS

EG-4010		
Bending capacity	kN	400
Beam length	mm	1050
Distance between frames	mm	710
Open height	mm	420
Upper beam stroke	mm	150
Working height	mm	980*
Power consumption (only Y axis servo motor)	kW	5.3
Oil capacity	l	-
Approach speed (with additional protection option)	mm/s	220
Bending speed	mm/s	25**
Return speed	mm/s	220
Positioning accuracy	mm	+/- 0.001
Noise level***	dB	65.5 - 67.6
Machine mass	kg	2700

*Without die holder

**Depending on V- size

*** Depending on operator position

5-AXIS BACK GAUGE

		X AXIS	R AXIS	Z AXIS
Operating stroke	mm	300	150	622
Speed	mm/s	1000	333	1000
Accuracy	mm	±0.003	±0.05	±0.02

The specifications, appearance and equipment are subject to change without notice due to improvement.



For Your Safety

Please read the user manual before use. Before using this machine, please familiarise yourself with the risks.

The use of this product requires appropriate risk prevention measures depending on the type of work to be performed. The safety devices recommended by AMADA are supplied as standard for proper use with regard to EC conformity.

The official name of the machine described in this brochure is EG-4010. Please use this reference when contacting authorities to apply for financing, installation or exporting. The machine name may contain a hyphen for easier reading. Safety devices have been removed in some photos used in this brochure.

AMADA UK LTD.

Spennells Valley Road,
Kidderminster,
Worcestershire DY10 1XS
United Kingdom
Tel: +44 (0)1562 749500
Fax: +44 (0)1562 749510
www.amada.co.uk

AMADA SA

Paris Nord II
96, avenue de la Pyramide
93290 Tremblay en France
France
Tél : +33 (0)1 49 90 30 00
Fax : +33 (0)1 49 90 31 99
www.amada.fr

AMADA GmbH

Amada Allee 1
42781 Haan
Germany
Tel: +49 (0)2104 2126-0
Fax: +49 (0)2104 2126-999
www.amada.de

AMADA ITALIA S.r.l.

Via Amada I., 1/3
29010 Pontenure
(Piacenza)
Italia
Tel: +39 0523 872111
Fax: +39 0523 872101
www.amada.it

